

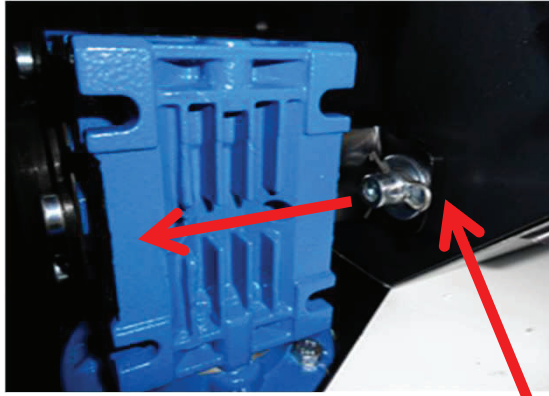

Belt replacement
central flat belt
conveyor

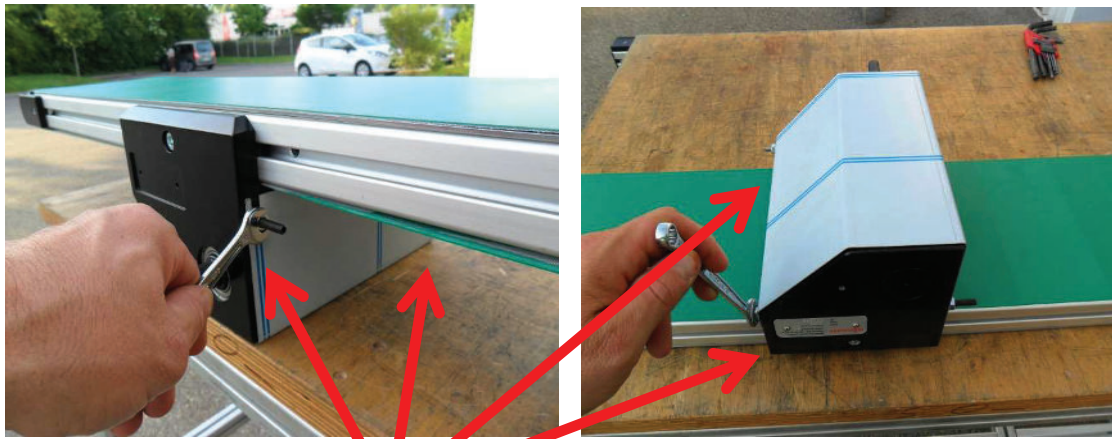

- 1 - Remove the pin and the washer.
- 2- Pull the motor in the opposite direction of the flat belt conveyor.



- 3 - Loosen the four H M6 nuts with an open-ended spanner (number 10).

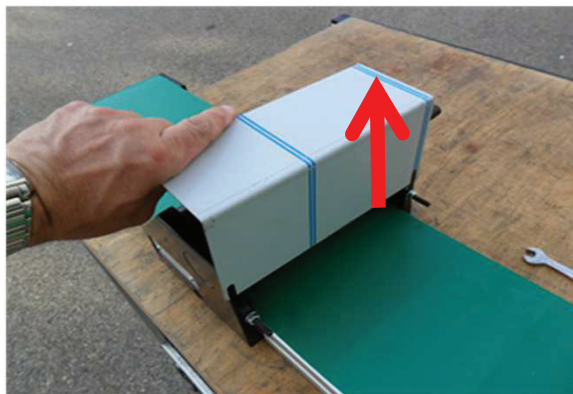

- 4 - Remove the cover by sliding it.

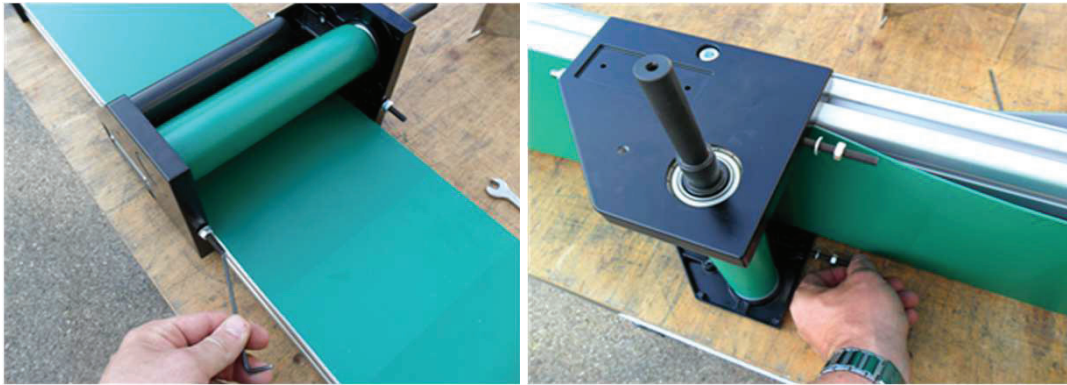

5 - Loosen the 6x90 black bolt nuts to release the belt.

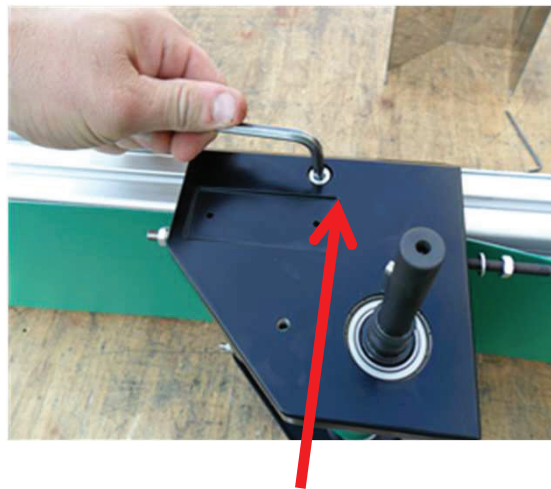

6 - Unscrew the CHC 8x16 nut with a BTR spanner.

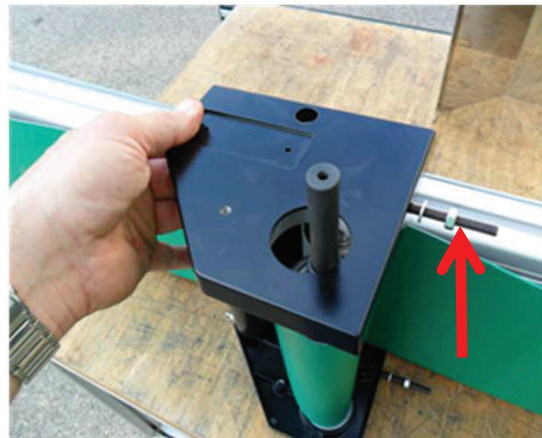

7 - Remove the flange to reach the belt.



8 - Remove the belt. Be careful not to let the pulleys and the little stainless steel washers on the side of each pulley



9 - Put the new belt at the same place while making sure that the belt path between the pulleys is correct.

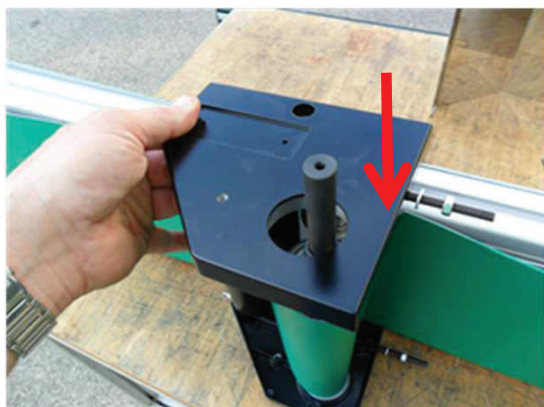

10 - Put the flange back while making sure that the shafts are placing themselves in the right housings.



11- Before tightening the CHC 8x16 nut make sure with a flat angle bracket that the flange alignment is correct.



12 - Lay a tape measure on the conveyor.

13 - Draw a dot at 0 mm and another one at 500 mm while being as precise as possible.

14 - Stretch the belt with the two HC 6x90 nuts.



15 - Stretch the belt until you get 502,5mm.

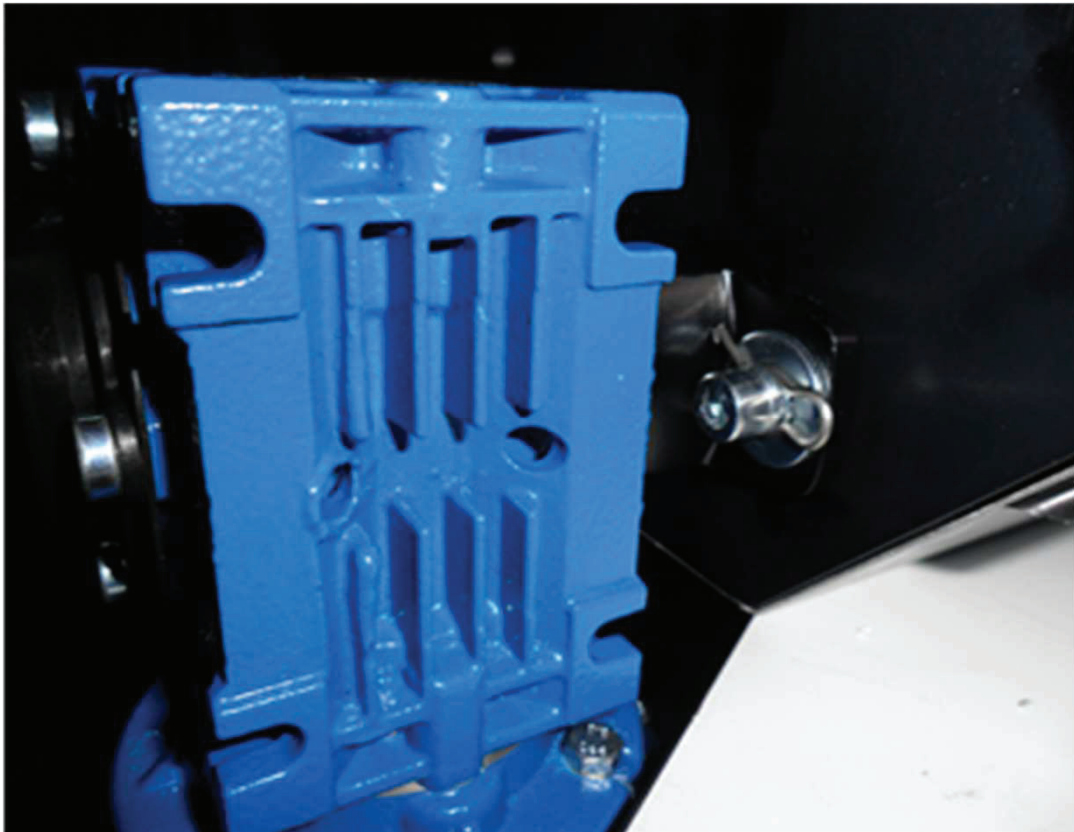

16 - Mount back the motor in reverse order.

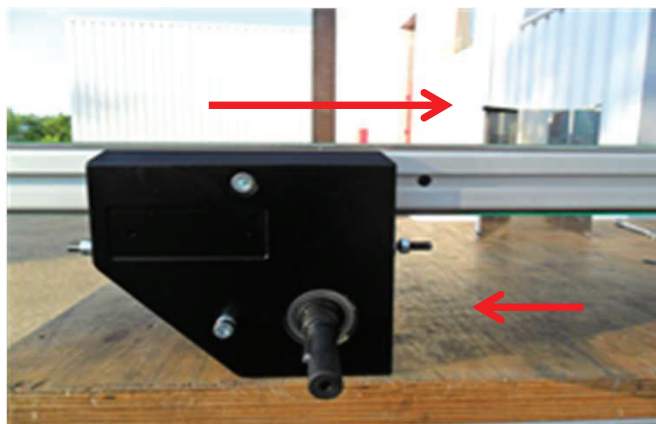

17 - Belt standard driving direction and settings.

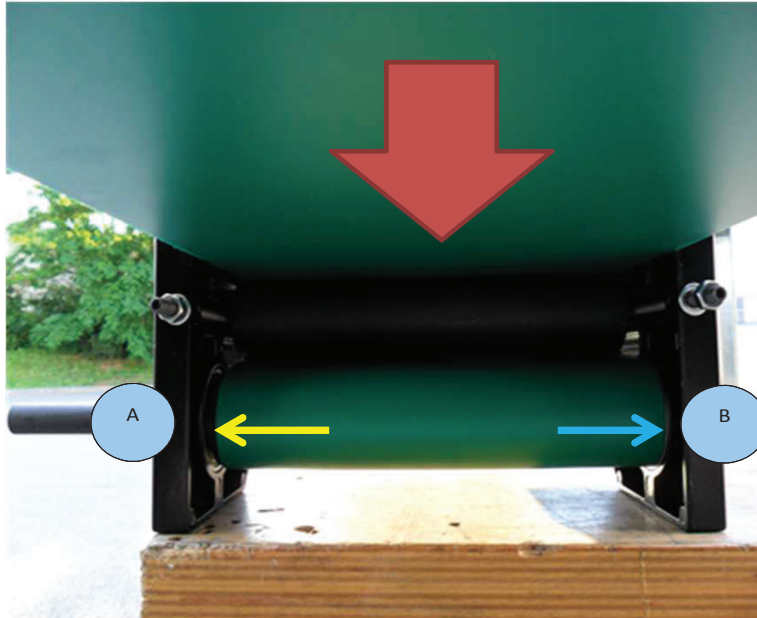

If the belt goes on to the left side, the reference point A must be screwed to send the belt to the right.



If the belt goes on to the right side, the reference point B must be screwed to send the belt to the left.

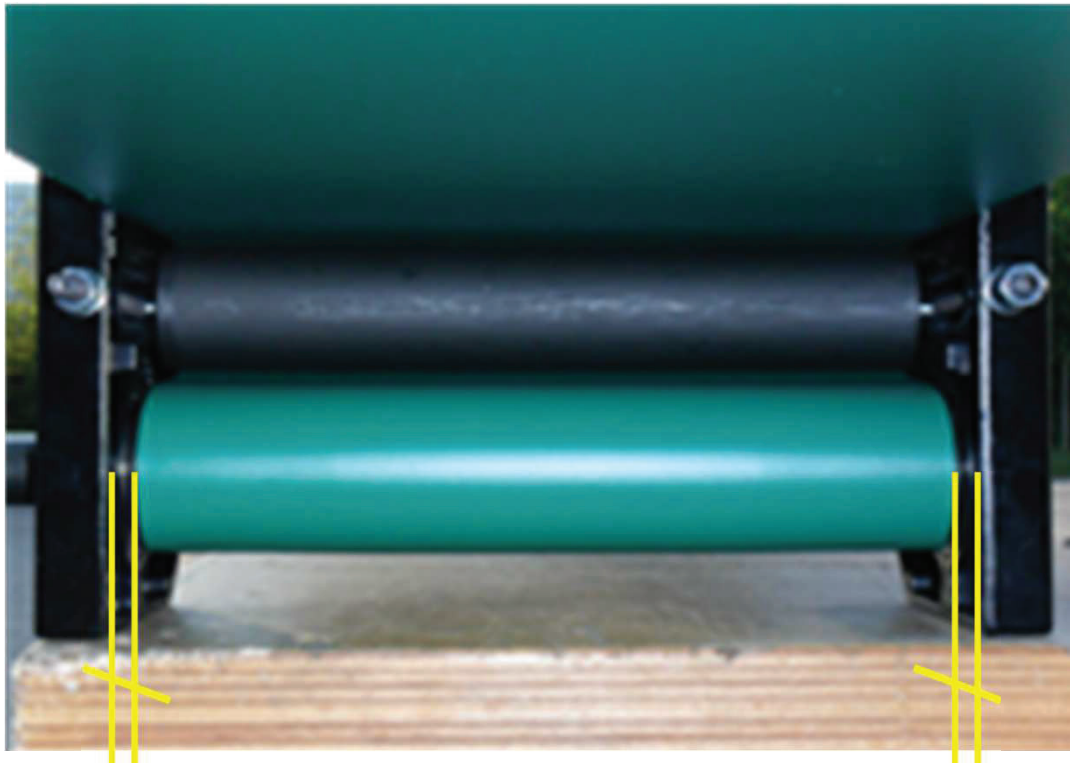

18 - Make sure of the centring of the belt by using the 2 black nuts until you obtain the same slack on each side of the flanges.

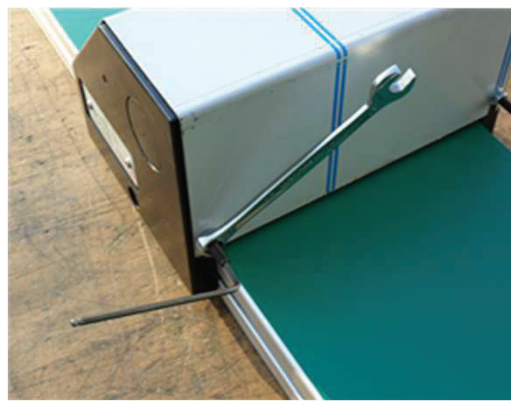
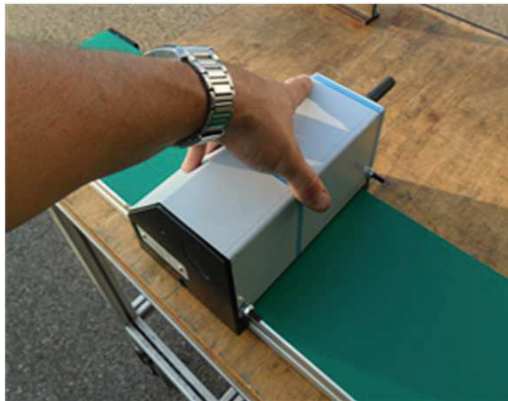

19 - Put the cover back while taking care of not moving the nuts. In order to do so, use a BTR 3 spanner then tighten the H6 nuts with an open- ended spanner (number 10).

Liability

Elcom SAS cannot be held as responsible for any damages or injuries resulting from non allowed modifications of various items and particularly safety equipment.

Only original components can be used for the maintenance and repairing.
Nor shall Elcom SAS be liable for any malfunction if the spare parts used have not received Elcom's prior authorisation.

Elcom SAS reserves the right to carry out improvements and technical modifications without notice.

Elcom SA
1 rue Isaac Asimov
ZAC la Maladière
F-38300 BOURGOIN JALLIEU
Tél: 04.74.43.99.61 Fax: 04.74.28.59.02
elcom38@hellomoov.com

