

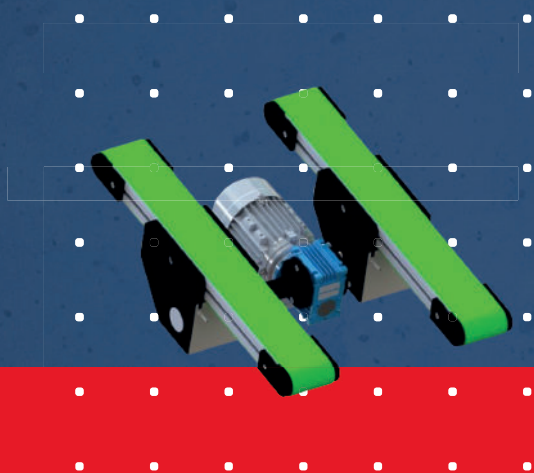

# Technical sheet Roller conveyor



**elcom**  
by hellomoov

## CONVEYOR WITH NON DRIVEN ROLLERS







# Conveyor with non driven rollers

## Straight line

Widths 350, 450, 550, 650 mm

### Technical data

Straight compact conveyor to convey all types of cardboard boxes, flat bottom boxes, etc. on zinc-plated steel rollers.

Aesthetic design.

### Dimensions (mm)

- ✗ Width A: 350 - 450 - 550 - 650
- ✗ Rollers: Ø 50
- ✗ X: quantity of rollers
- ✗ P: pitch between rollers  
55 - 75 - 95
- ✗  $L = (X-1) \times P + 54$
- ✗ Maximum load per roller (daN) : 6

Composed of modular elements, fully adaptable to the aluminium profiles range.

### Options

- ✗ Feet or frame in aluminium
- ✗ Lateral guides
- ✗ Pitch between the rollers on request
- ✗ Fixed stopper

### Permissible load:

according to widths, lengths and pitch between rollers.

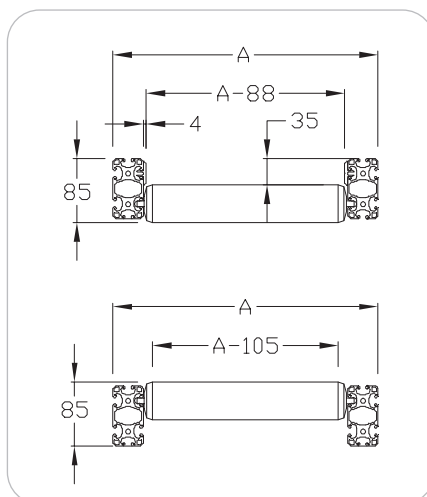

avec rives

sans rive

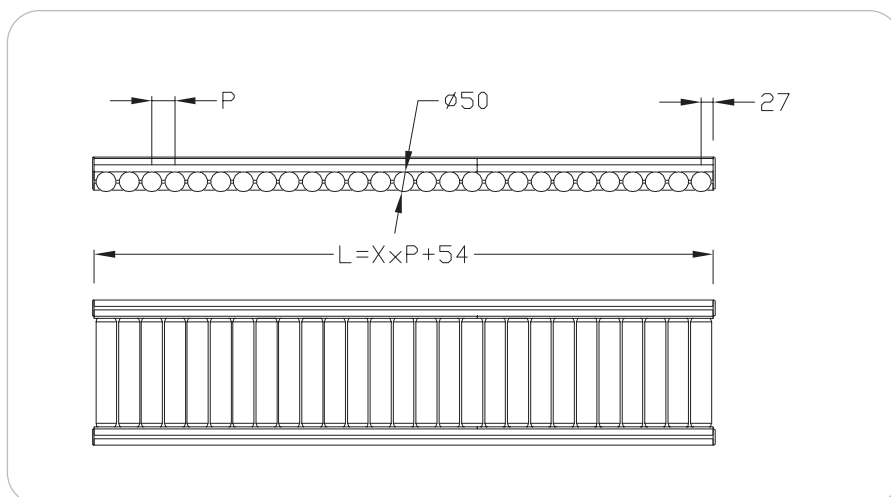

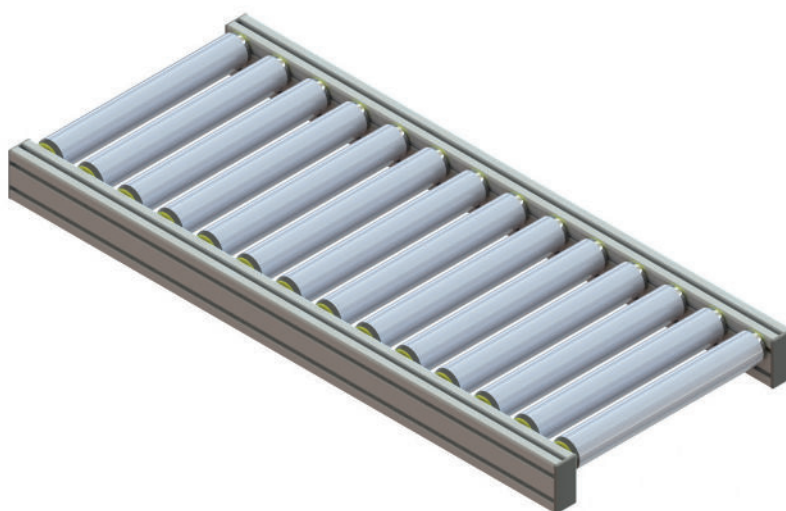

Product description/Dimensions	Order unit	Reference
Conveyor with non driven rollers Straight line	1 pce	CR XXX 52 000
Conveyor with non driven rollers with lateral guides Straight line	1 pce	CR XXX 53 000

(XXX = Width A of conveyor : 350-450-550-650 ex. : CR 350 52 000)

# Conveyor with non driven rollers

## Curved line

Widths 350, 450, 550, 650 mm

### Technical data

Compact conveyor with a curve to convey all types of cardboard boxes, flat bottom boxes, etc. on truncated-cone shaped rollers.

Composed of modular elements, fully adaptable to the aluminium profiles range.

Aesthetic design.

### Dimensions (mm)

- ✗ Width A: 350 - 450 - 550 - 650
- ✗ Zinc plated steel rollers with PVC coating
- ✗ Pitch between rollers P:  
75 on R 820
- ✗ Maximum load per roller (daN): 6
- ✗ Inner radius of curvature: 780

Made up of modular elements, fully adaptable to the aluminium profile range.

### Options

- ✗ Feet or frame in aluminium
- ✗ Lateral guides

Permissible load:  
according to widths, lengths and pitch  
between rollers.

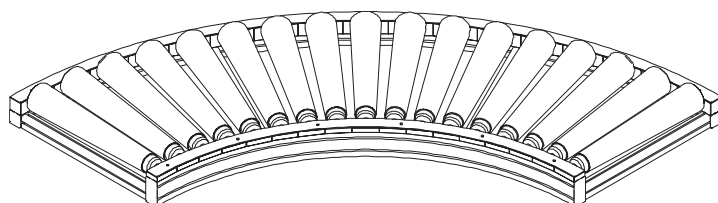
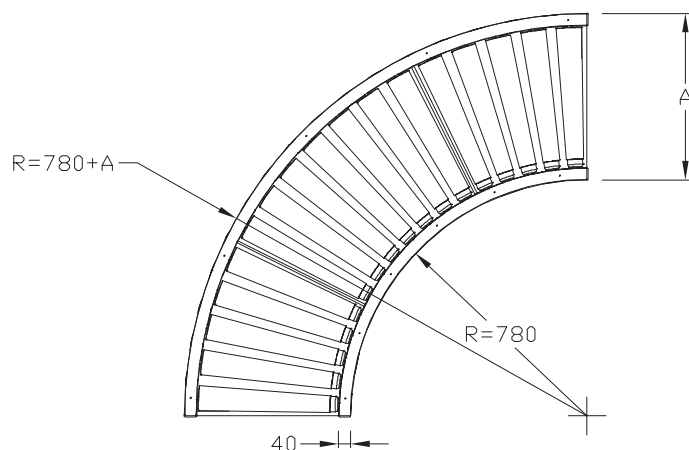
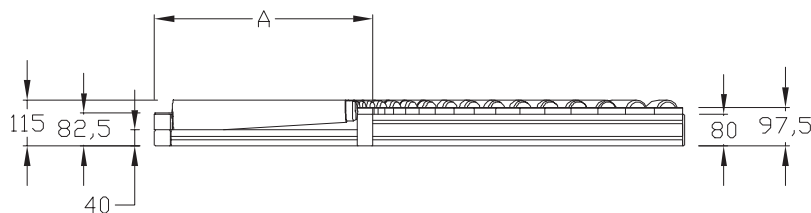

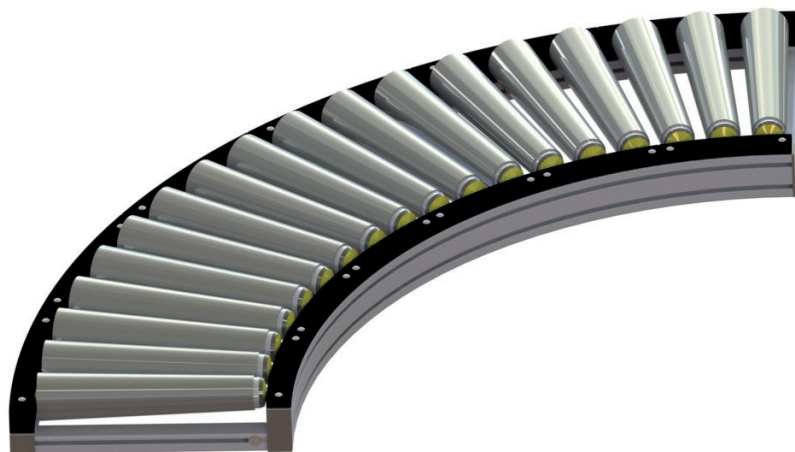

Product description/Dimensions	Order unit	Reference
Conveyor with non driven rollers Curved	1 pce	CRC XXX 52 000

(XXX = Width A of conveyor : 350-450-550-650 ex.: CRC 350 52 000)

## Conveyor with non driven rollers

### Straight or curved lines

The intelligent motorized conveyor to rollers transports products while managing accumulation autonomously.

Internal control of conveyor to rollers ensures pressure-free accumulation transport of isolated loads.

Each zone is driven by a motorized roller connected to a fixed number of free rollers with Poly-v belts. No master control system is required.

When a single load enters, it systematically activates the next zone when it reaches the end of the zone. Loads do not touch each other and are accumulated without pressure as required.

This system ensures a homogeneous conveying flow, as well as buffer mode operation for gentle product conveying, without automation.



**Straight section**

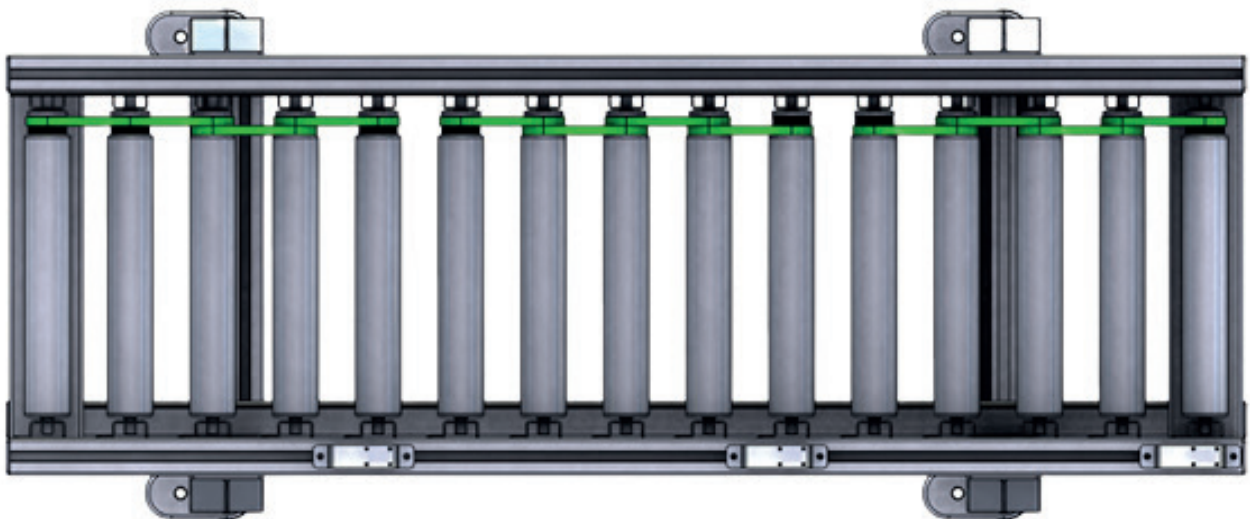
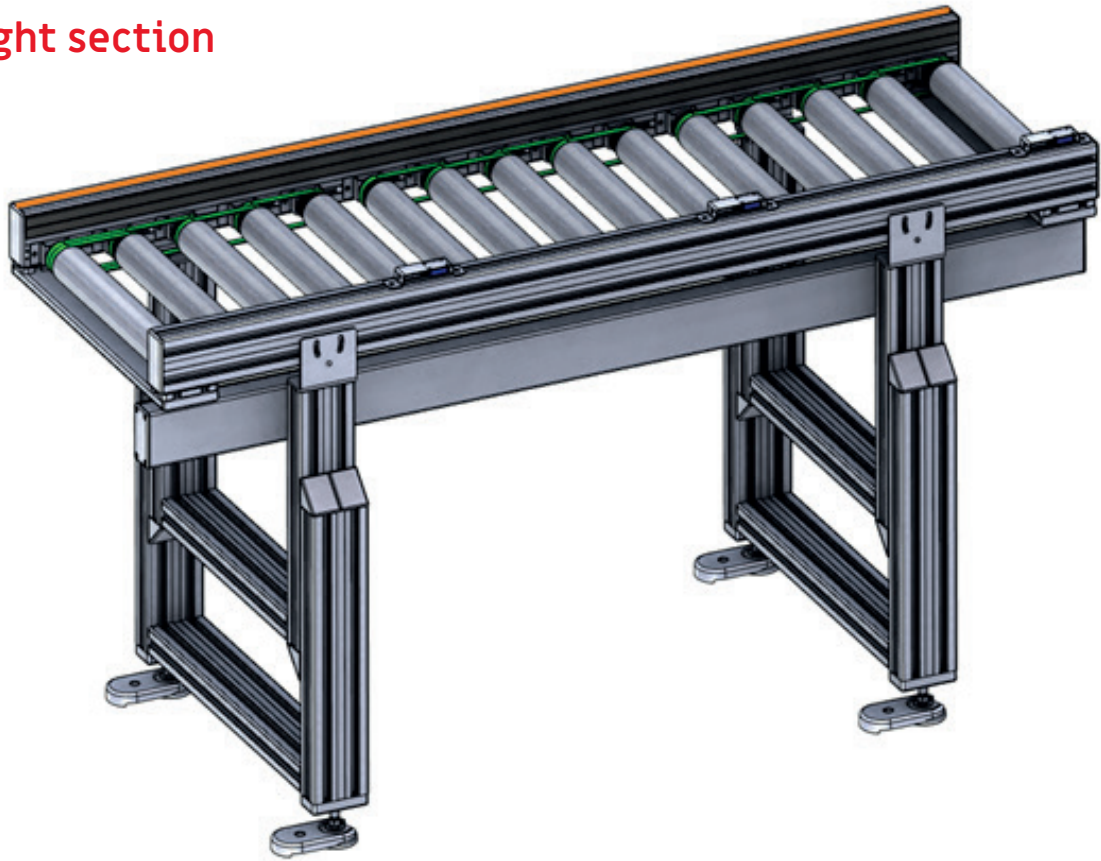

# Conveyor with motorized rollers - characteristics

## / Product benefits

Modularity  
Easy maintenance  
Operator safety  
Energy-saving (24v rollers)  
Plug & play operation thanks to stand-alone boards

## / Environment

Indoor use only

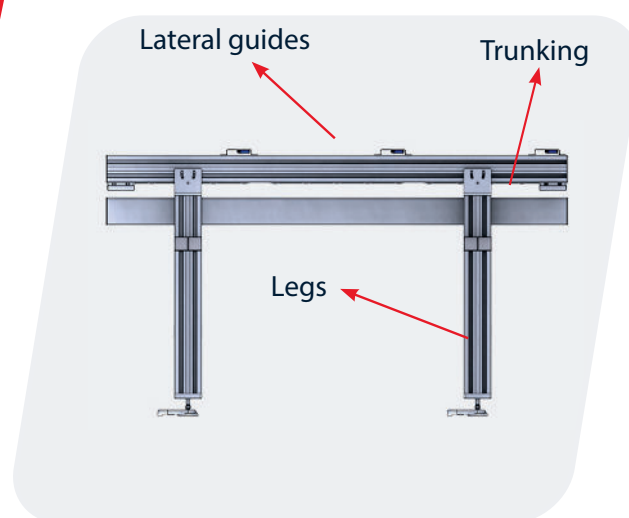

DC brushless motor		24 VDC (+/- 10 %) - Ripple rate < 10			
Insulation class		E			
Operation at 40°C	Continuous	100%			
	Intermittent	1800 starts / hour max Minimum cycle time = 1 s ON / 1 s OFF ED = ON / (ON+OFF) ≤ 50			
Brake		Dynamic braking			
Protection class		IP54 (IP65 or cold room version, consult us)			
Cable length		300 mm with JST connector - 9 pins			
Protection		Thermal protection (>95C for the circuit board, >110C for the motor) Protection against induced voltage			
Environment		0 / +40 °C - no condensation - no corrosive or explosive atmosphere Vibrations <0.5 G			
Noise level		52 dB nominal at 1 metre distance			
Speed code		15	25	55	90
Reduction ratio		1/44,90	1/26,67	1/12,64	1/7.5
Connector		JST#S9B-XH-A Male 9-pin			

**Straight section**

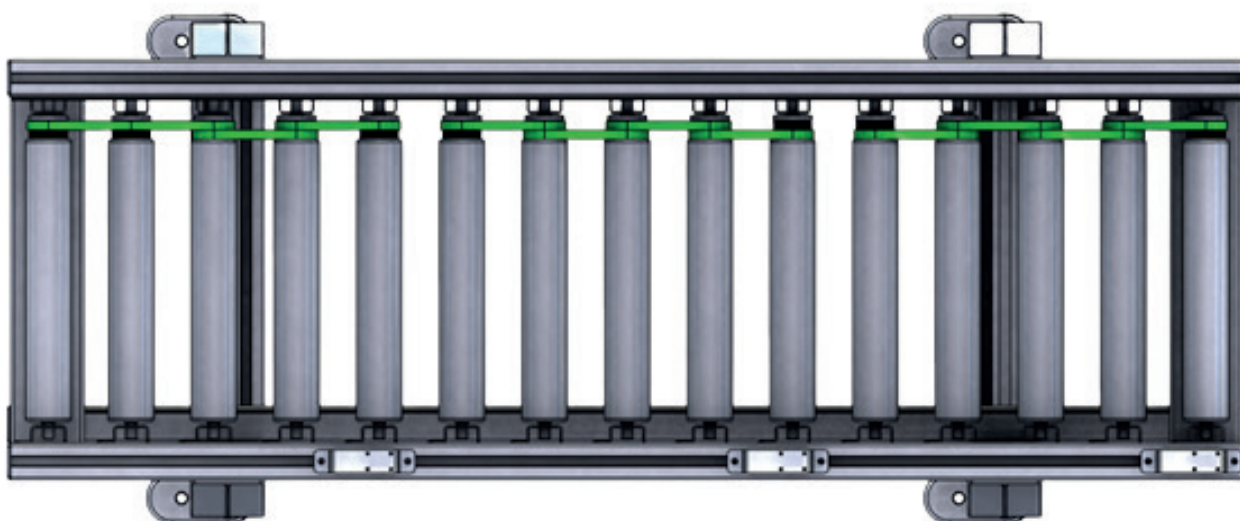
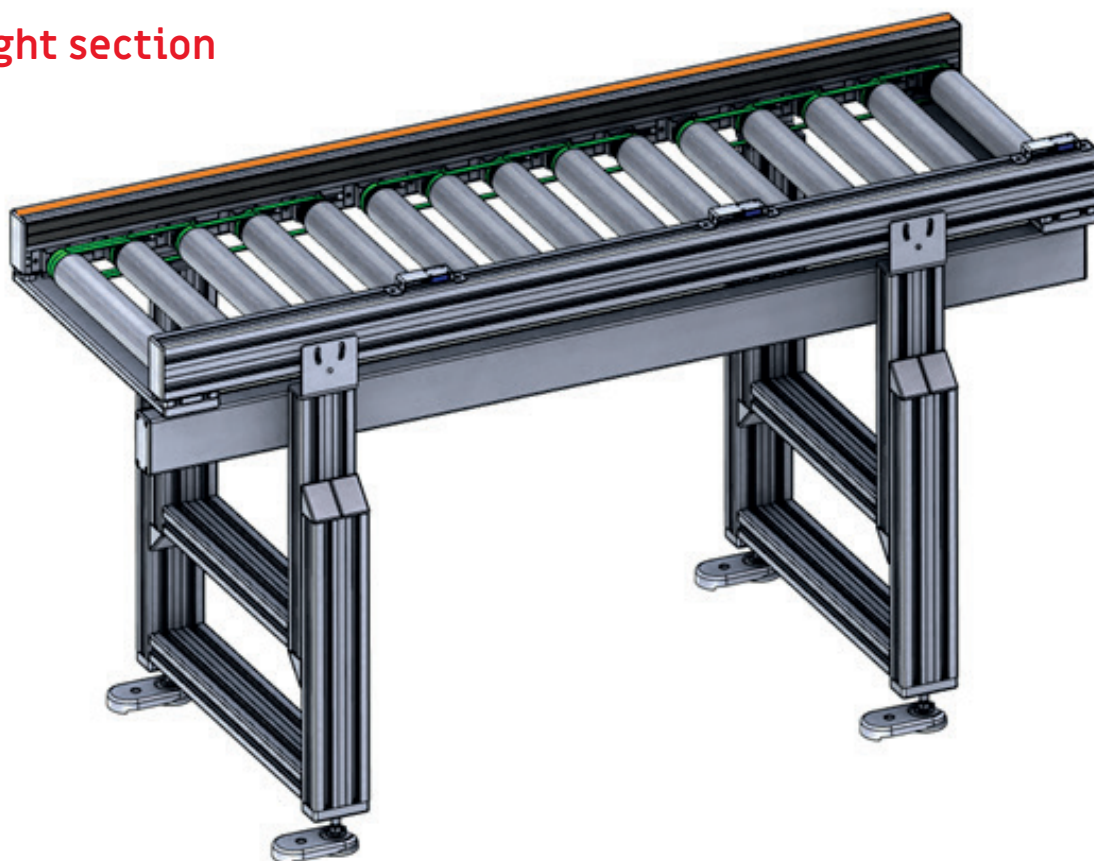

# Transfer capacity

## Conveyor to rollers moteur intelligent

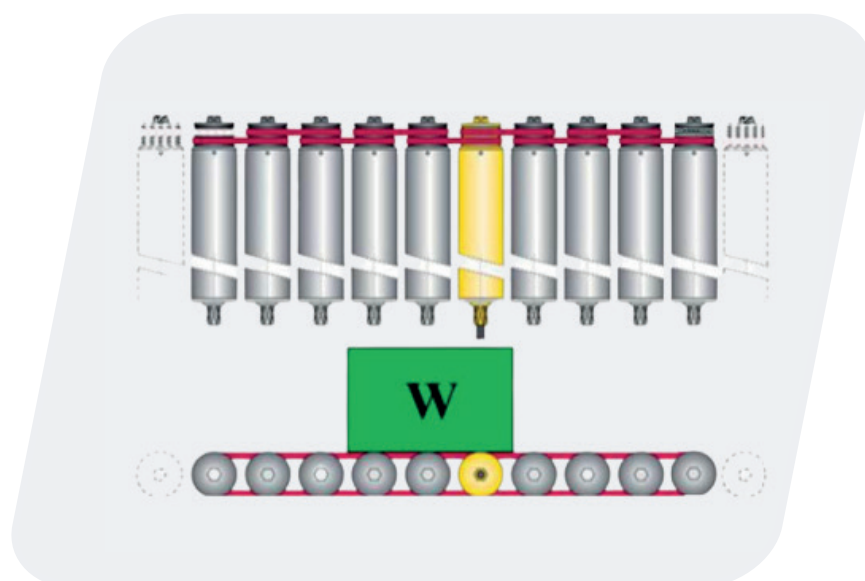

With board ref. 11464

Code speed 15

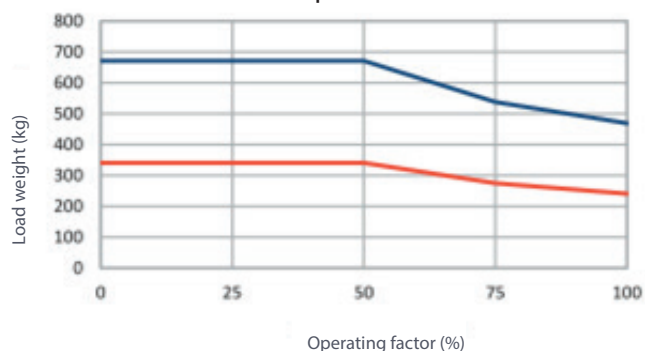

Code speed 25

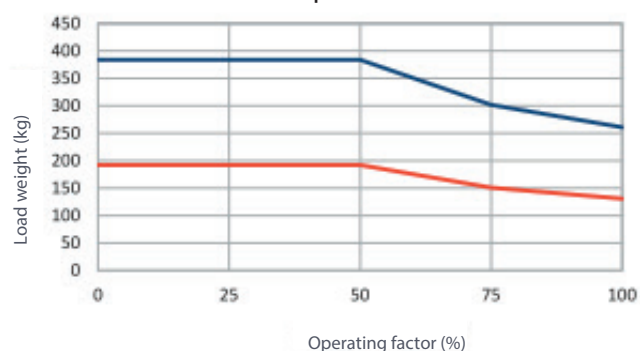

Code speed 55

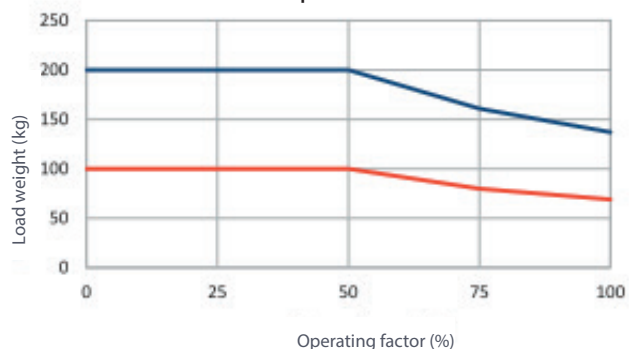

- Load to be transported
- Plastic crate ( $p = 0,03$ )
- Cardboard box ( $u = 0,06$ )
- 9 free rollers driven by 1 motorized roller
- Ambient temperature 30°C

*These curves are given for information only. Transfer capacity may vary depending on the nature and quality of the load to be conveyed, belt tension, bearing quality, type of sleeve, ambient temperature, etc.*



With board ref. 12805

Code speed 15

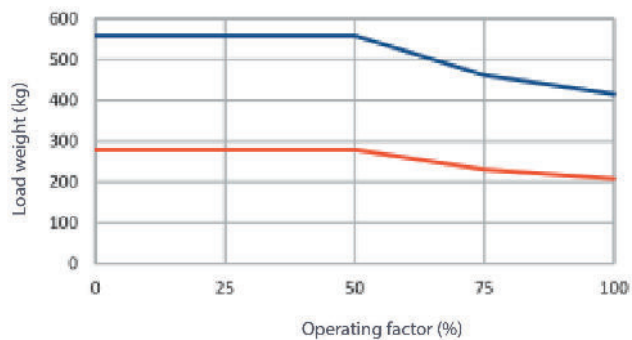

Code speed 25

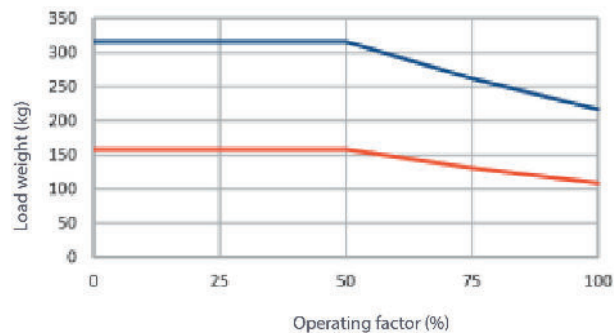

Code speed 55

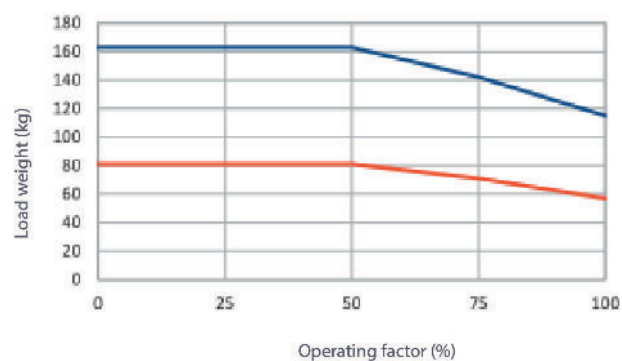

- Load to be transported
- Plastic crate ( $p = 0,03$ )
- Cardboard box ( $u = 0,06$ )
- 9 free rollers driven by 1 motorized roller
- Ambient temperature 30°C

*These curves are given for information only. Transfer capacity may vary depending on the nature and quality of the load to be conveyed, belt tension, bearing quality, type of sleeve, ambient temperature, etc.*

# Dimensions

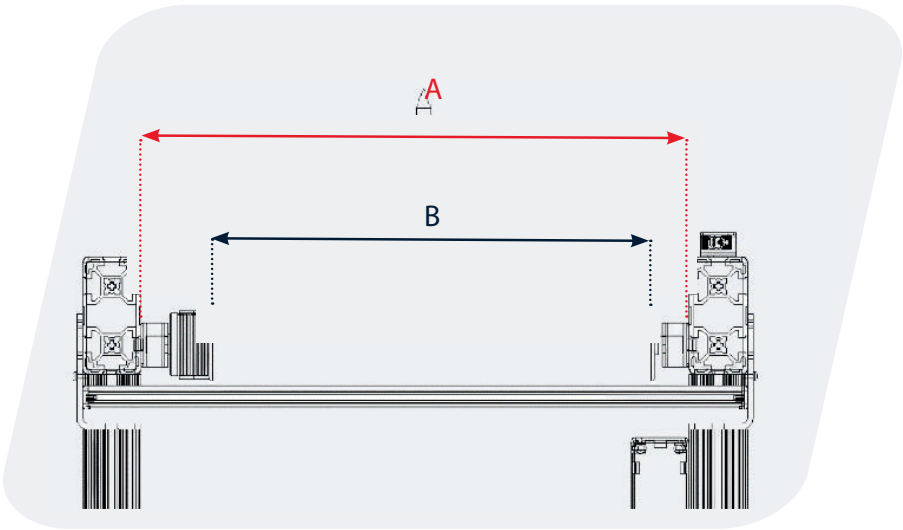

Code speed	Dimension A	tube length B
	Mini ≤ A ≤ Maxi	Mini ≤ B ≤ Maxi
15	371 ≤ A ≤ 1276	295 ≤ B ≤ 1200
25 / 55	346 ≤ A ≤ 1276	270 ≤ B ≤ 1200
90	316 ≤ A ≤ 1276	240 ≤ B ≤ 1200

Tube length		300	400	500	600	700	800	900	1000	1100	1200
Weight (kg)	15m/ min	2,8	2,9	3,1	3,2	3,4	3,6	3,7	3,9	4,1	4,2
	25m/ min	2,5	2,7	2,9	3,0	3,2	3,4	3,5	3,7	3,9	4,0
	55m/ min	2,6	2,7	2,9	3,1	3,2	3,4	3,6	3,7	3,9	4,0
	90m/ min	2,3	2,4	2,6	2,8	2,9	3,1	3,2	3,4	3,6	3,7
Max static load (Kg)		65	55	45	35	30	25	20	20	15	15
Max. axial force (N)		290									

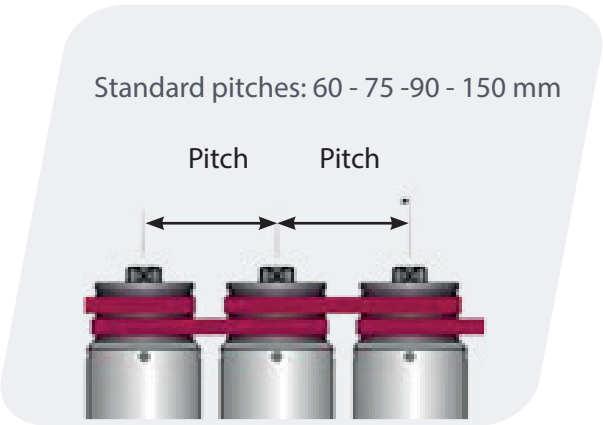

## Other pitches available

Pitch between rollers (mm) for Ø43 mm pulley				
60-63	73-75	87-91	115-118	142-147
64-65	73-77	92-95	119-121	150-156
66-67	78-79	97-101	123-128	157-161
71-72	80-84	103-107	129-134	170-176

# Determination sheet

Roller conveyor length  mm      pitch of rollers  mm

Width of roller conveyor  mm

Clear width	450	650	850	1200	
PITCH 60 mm	CRM-METRE-0450-060	CRM-METRE-0650-060	CRM-METRE-0850-060	CRM-METRE-1200-060	Conveyor metre
PITCH 90 mm	CRM-METRE-0450-090	CRM-METRE-0650-090	CRM-METRE-0850-090	CRM-METRE-1200-090	
PITCH 150 mm	CRM-METRE-0450-150	CRM-METRE-0650-150	CRM-METRE-0850-150	CRM-METRE-1200-150	
SPEED 15	CRM-VIT-0450-15	CRM-VIT-0650-15	CRM-VIT-0850-15	CRM-VIT-1200-15	Number of zones
SPEED 25	CRM-VIT-0450-25	CRM-VIT-0650-25	CRM-VIT-0850-25	CRM-VIT-1200-25	
SPEED 55	CRM-VIT-0450-55	CRM-VIT-0650-55	CRM-VIT-0850-55	CRM-VIT-1200-55	
H1 : from 610 to 890 mm	CRM-JAMB-0450-H1	CRM-JAMB-0650-H1	CRM-JAMB-0850-H1	CRM-JAMB-1200-H1	Number of jambes
H2 : from 710 to 1090 mm	CRM-JAMB-0450-H2	CRM-JAMB-0650-H2	CRM-JAMB-0850-H2	CRM-JAMB-1200-H2	
H3 : from 850 to 1350 mm	CRM-JAMB-0450-H3	CRM-JAMB-0650-H3	CRM-JAMB-0850-H3	CRM-JAMB-1200-H3	

## CONVEYOR WITH MOTORIZED ROLLERS





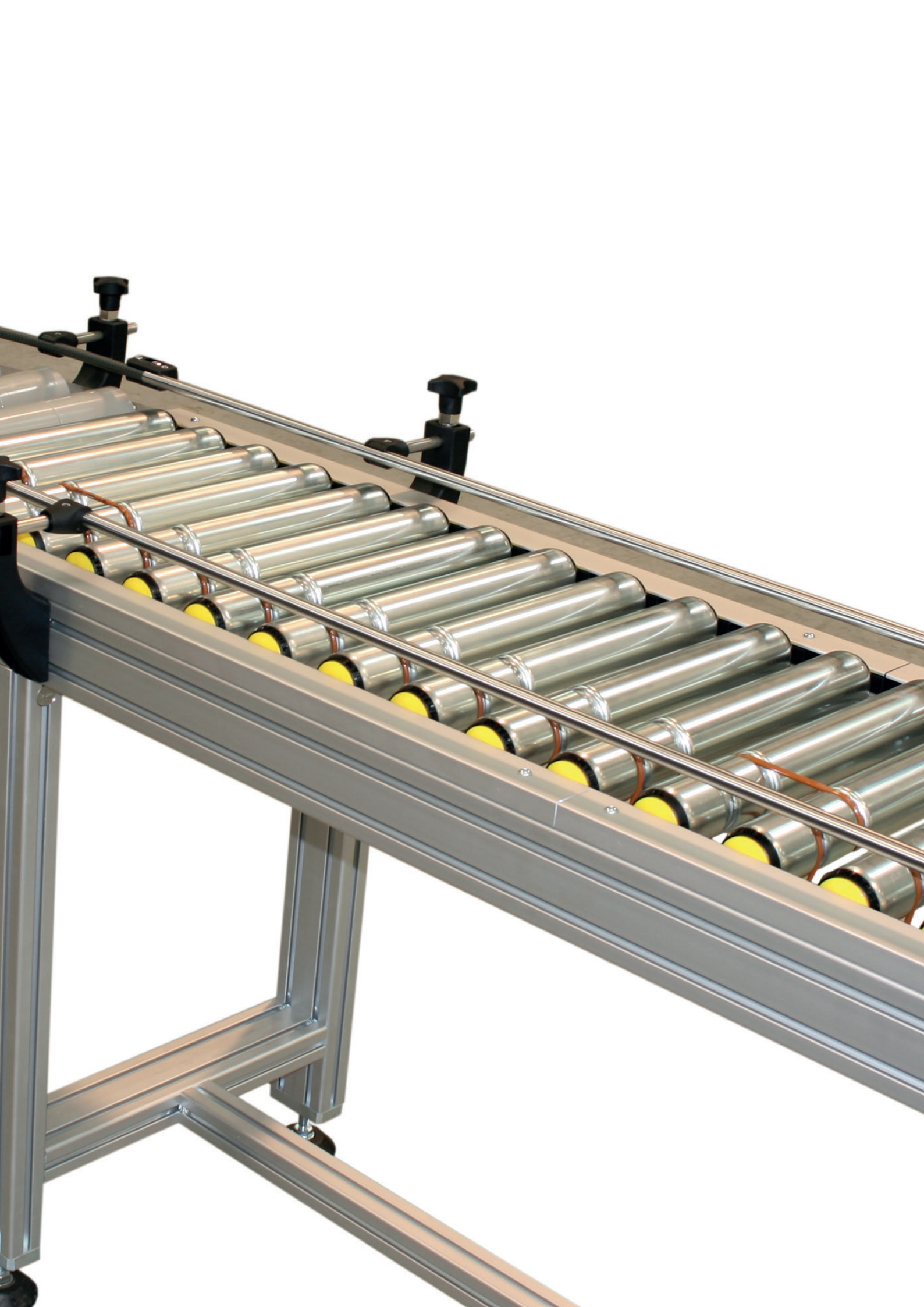

# Conveyor with motorized rollers

## Curved line

Widths 450, 550, 650 mm

### Technical data

Compact motorized conveyor with a curve to convey all types of cardboard boxes, flat bottom boxes, etc. on truncated-cone shaped rollers.

The curved conveyor can be driven by the straight conveyor associated or not.

Composed of modular components, fully adaptable to the aluminium profiles range.

Aesthetic design.

### Dimensions (mm)

- ✗ Width A: 450 - 550 - 650
- ✗ Zinc-plated steel rollers with PVC coating
- ✗ Pitch between rollers P:  
65 on R 712
- ✗ Maximum load per roller (daN): 6
- ✗ Inner radius of curvature: 672

### Gear motors

Rollers motorization by round belt

Speeds (m/min) : 6 - 7 - 9 - 12 - 18 - 24

Made up of modular elements, fully adaptable to the aluminium profile range.

### Options

- ✗ Feet or frame in aluminium
- ✗ Lateral guides
- ✗ Lateral guides de guidages

Permissible load:

en fonction des largeurs, longueurs and pas entre les rollers.

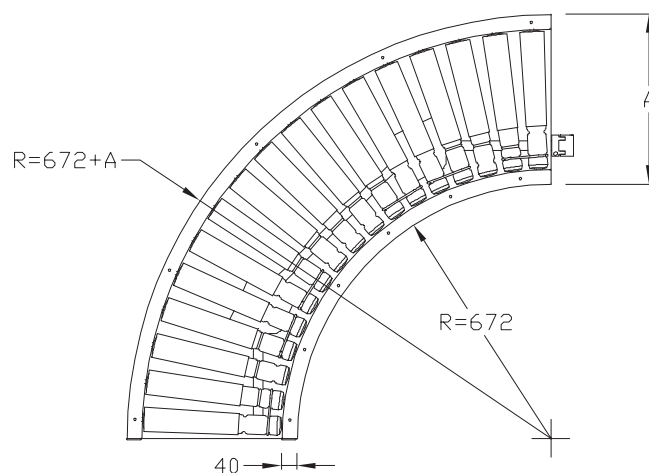
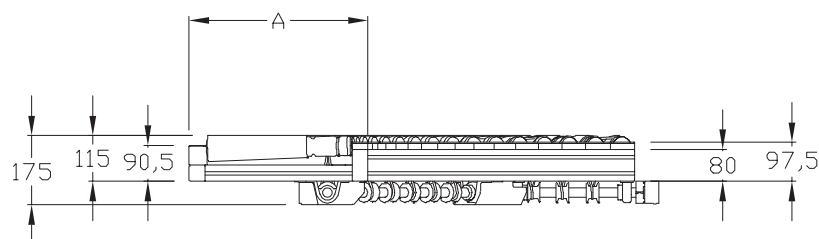

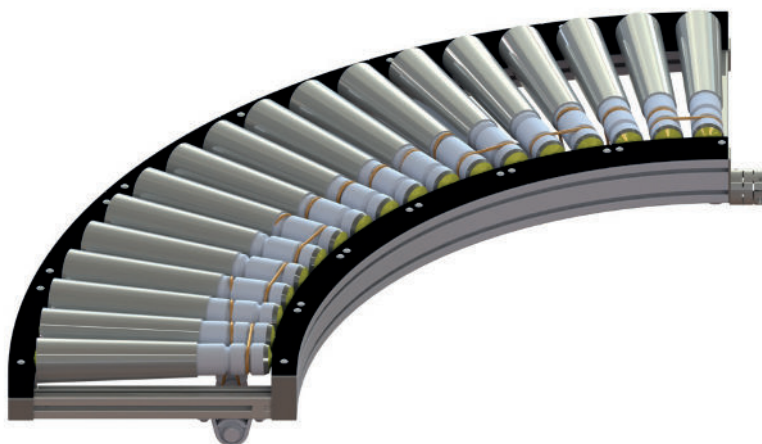

Product description/Dimensions	Order unit	Reference
Conveyor with motorized rollers Curved line	1 pce	CRC XXX 50 000

(XXX = Width A of conveyor: 450-550-650 eg: CRC 450 50 000)

# Conveyor with motorized rollers

## Straight line

Widths 350, 450, 550, 650 mm

### Technical data

Straight compact conveyor to convey all types of cardboard boxes, flat bottom boxes, etc. on zinc-plated steel rollers.

Aesthetic design.

### Dimensions (mm)

- ✗ Width A: 350 - 450 - 550 - 650
- ✗ Rollers: Ø 50
- ✗ X: quantity of rollers
- ✗ P: pitch between rollers : 55 - 75 - 95
- ✗  $L = (X-1) \times P + 55$
- ✗ Maximum load per roller (daN) : 6

### Gear motor

Rollers motorization by round belt

Speeds (m/min) : 6 - 7 - 9 - 12 - 18 - 24

Made up of modular elements, fully adaptable to the aluminium profile range.

### Options

- ✗ Feet or frame in aluminium
- ✗ Lateral guides
- ✗ Pitch between the rollers on request
- ✗ Fixed stopper
- ✗ Distributing stopper
- ✗ Acceleration zone

Speed = conveyor speed x 1.25

Permissible load:

according to widths, lengths and pitch between rollers.

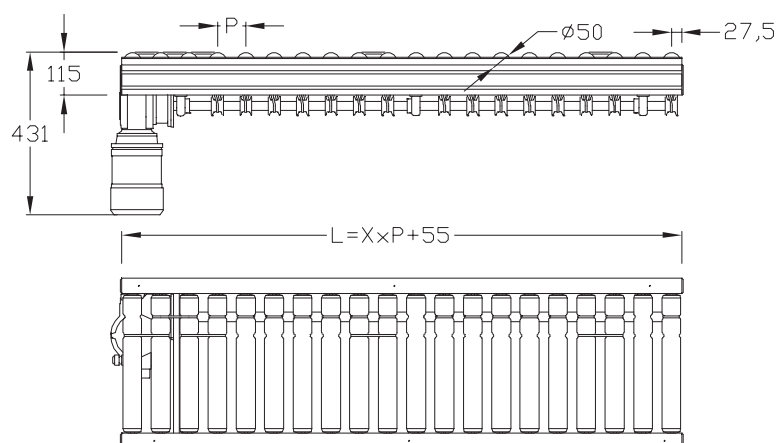
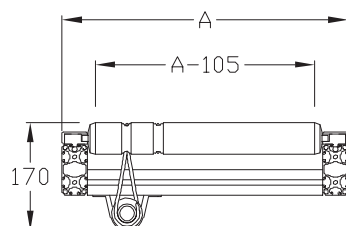





Product description/Dimensions	Order unit	Reference
Conveyor with motorized rollers Straight line	1 pce	CR XXX 50 000

(XXX = Width A of conveyor: 350-450-550-650 eg: CR 350 50 000)